

## GROUNDING BRUSHES

### CARBON BRUSHES FOR PROPELLER SHAFT GROUNDING

Carbex produces and supplies brushes for propeller shaft grounding on ocean going vessels around the world. Propeller shaft bearings are vulnerable to corrosion. This is because turning shafts are electrically insulated from the hull by the lubricating oil in the bearings and by the use of non-metallic bearings in the tail shaft. The problem is eliminated when the propeller shaft is grounded to the hull structure using a shaft slip ring

equipped with Carbex high silver content brushes developed to give optimum performance. A specification that provides the best combination of conductivity and wear resistance. Carbex produces all kinds of brushes – below you can find a selection of common grounding brushes. Do you need something different? Please use the form on the back page for specials – or simply give us a call.



**PART NO. 1018-CR**  
Material: CAG, Model: 504  
Dimensions: 8x4x16 mm



**PART NO. 1019-CV**  
Material: CA20, Model 601  
Dimensions: 20x10x32 mm  
Flexible: FS 4mm<sup>2</sup>-100 mm  
Terminal SRO-6



**PART NO. 4508-CV**  
Material: CA20, Model 600  
Dimensions: 25x10x32 mm  
Flexible: FS 6 mm<sup>2</sup>-90 mm  
Terminal SRO-6



**PART NO. 9653-CV**  
Material: CA20, Model 700  
Dimensions: 20x12,5x40 mm  
Flexible FS 3,2 mm<sup>2</sup>-120 mm  
Terminal: SRS-6



**PART NO. H102032**  
Material: CAG, Model: 601  
Dimensions: 20x10x32 mm  
Flexible: FS 4 mm<sup>2</sup>-80 mm  
Terminal SRO-6



**PART NO. 1869-CR**  
Material: CAG, Model 601  
Dimensions: 25x10x32 mm  
Flexible FS 6 mm<sup>2</sup>-90mm  
Terminal: SRO-6



**PART NO. 7836-CV**  
Material: CA20, Model 600  
Dimensions: 25x10x32 mm  
Flexible: FS 6 mm<sup>2</sup>-90 mm  
Terminal: SRO-8



**PART NO. 1879-CV**  
Material: CA20, Model 601  
Dimensions: 25x12,5x32 mm  
Flexible FS 6mm<sup>2</sup>-87 mm  
Terminal: SRO-6



**PART NO. 5699-CV**  
Material: CA20, Model 600  
Dimensions: 20x10x32 mm  
Flexible: FS 6 mm<sup>2</sup>-95 mm  
Chamfers: 4x2 mm  
Material: CAG=9396 silver,  
CA20= 8096 silver



PRODUCT AND DATA  
SHEETS FOR  
DOWNLOAD

### BRUSH HOLDERS – FOR GROUNDING BRUSHES

Carbex also supplies different kinds of brush holders. Don't hesitate to ask!



BEYOND THE BOUNDARIES OF BRUSH TECHNOLOGY

## CARBON BRUSH ACQUISITION FORM

Company: \_\_\_\_\_ Contact: \_\_\_\_\_ Order number: \_\_\_\_\_

Address: \_\_\_\_\_ Postal code: \_\_\_\_\_ Delivery postal address: \_\_\_\_\_

Phone: \_\_\_\_\_ Fax: \_\_\_\_\_ E-mail: \_\_\_\_\_ Country: \_\_\_\_\_

DELIVERY DATE 20 / /

### BRUSH DATA

Quantity \_\_\_\_\_ pcs

Brand \_\_\_\_\_

Grade \_\_\_\_\_

Design No + \_\_\_\_\_ + \_\_\_\_\_

Other  Silver graphite,  Silver graphite,   
CA20 80% AG CAG 93% AG

### DIMENSIONS

Tangential t \_\_\_\_\_

Axial a \_\_\_\_\_

Radial r \_\_\_\_\_

### FLEXIBLE

Quantity \_\_\_\_\_

Length \_\_\_\_\_

Insulation Silicon  Glassfibre  Flexible silver plated

### TERMINAL

Type \_\_\_\_\_

Opening \_\_\_\_\_

### SKETCH AND NOTES

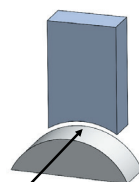
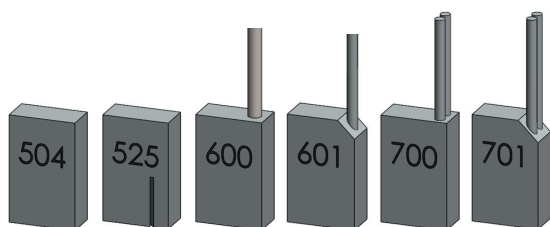

Radius.....mm

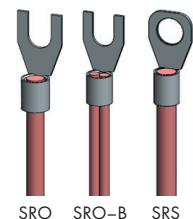
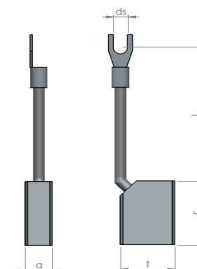

FOR MORE MODELS – PLEASE VISIT OUR WEBSITE!

BEYOND THE BOUNDARIES OF BRUSH TECHNOLOGY

**CARBEX AB**  
BOX 115, SE-592 22  
VADSTENA, SWEDEN

**PHONE**  
+46 (0)143-294 40

**MAIL**  
info@carbex.se

**WEB**  
carbonbrushsolution.com